

MAINLINE, GENERAL PURPOSE UNITS

F17 filter

3/4" PTF to 1-1/2" PTF port sizes

Screw-on bowl reduces maintenance time

Can be serviced without the use of tools or removal from the air line

Protects air operated devices by removing liquid and solid contaminants

TECHNICAL DATA

Fluid:

Compressed air

Maximum pressure:

250 psig (17 bar)

Operating temperature:*

-30° to 175°F (-34° to 80°C)

*Air supply must be dry enough to avoid ice formation at temperatures below 35°F (2°C)

Oil aerosol removal:

40 µm filter element

Air quality:

Within ISO 8573-1, Class 3 and Class 5 (particulates)

Nominal bowl size:

1 quart (1 liter)

Manual drain connection:

Will fit 1/8-27 and 1/8-28 male pipe thread.

Automatic drain connection:

Will fit 1/8-27 and 1/8-28 female pipe thread.

Materials

Body: Aluminum

Bowl: Aluminum

Bowl sight glass: Pyrex

Elastomers: Neoprene and nitrile

ISO Symbol

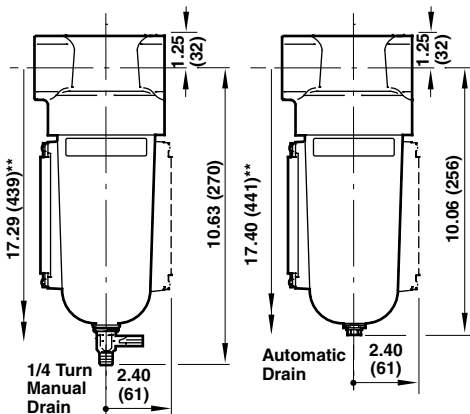
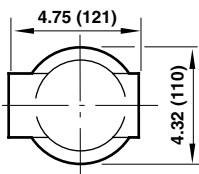
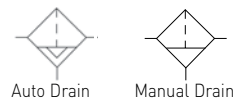

Models

F17 SERIES AUTO DRAIN Model No.	MANUAL DRAIN Model No.	Port size PTF	Flow SCFM* (dm³/s)	Element**
F17-600-A3DA	F17-600-M3DA	3/4"	325 (153)	40 µm
F17-800-A3DA	F17-800-M3DA	1"	425 (201)	40 µm
F17-A00-A3DA	F17-A00-M3DA	1-1/4"	425 (201)	40 µm
F17-B00-A3DA	F17-B00-M3DA	1-1/2"	425 (201)	40 µm

Accessories

Wall mounting bracket	Service kitt††	Replacement element (40 µm)**	Replacement element (5 µm)**
6212-50	5578-05	5311-03	5311-01
6212-50	5578-05	5311-03	5311-01
6212-51	5578-05	5311-03	5311-01
6212-50	5578-05	5311-03	5311-01

* Typical flow with a 40 µm element at 90 psig (6.3 bar) inlet pressure and 5 psig (0.35 bar) pressure drop.

** Filter elements are sintered bronze
†† Kit includes: Bowl O-ring, drain gasket, element gasket