

# R24 Micro-Trol Pressure Regulator

1/4" to 1-1/4" ports

ISO Symbol

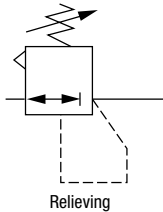

**High flow regulator with exceptional high relief flow**

**Adjusting knob can be set in the field to stop at some maximum pressure setting or some minimum pressure setting**

**Easy to adjust even at high output pressures**

**Balanced valve minimizes effect of variations in inlet pressure on outlet pressure**

**Constant bleed feature provides maximum sensitivity to system changes**

**Relieving feature allows reduction of downstream pressure when the system is dead-ended**

**Full flow gauge ports**

## Technical data

Fluid:

Compressed air

Maximum inlet pressure:

300 psig (20 bar)

Operating temperature:

0° to 150°F (-20° to 80°C)\*

\* Air supply must be dry enough to avoid ice formation at temperatures below 35°F (2°C).

Maximum bleed rate at 50 psig (3.5 bar) outlet pressure:

0.031 scfm (0.016 dm<sup>3</sup>/s) †

† Maximum bleed rate occurs under dead-end (no flow) conditions.

Port sizes:

Main	Gauge
1/4"	1/4"
3/8"	3/8"
1/2", 3/4", 1", 1-1/4"	1/2"

Thread type: PTF, ISO G, or Rc

## Materials

Body, top cap: Zinc

Main valve, adjusting screw: Brass

Pilot valve, relief valve: Acetal

Elastomers: Nitrile

Bottom Plug: Acetal

## Ordering Information.

Models listed are constant bleed units with relieving diaphragm, 10 to 125 psig (0.7 to 8 bar) outlet pressure adjustment range, and PTF threads.

Port Size	Model	Flow (scfm)	Weight lb (kg)
1/2"	R24-400-RGLA	200	1.79 (0.81)
1-1/4"	R24-A00-RGLA	700	2.65 (1.20)

## Alternative Models

Port Size	Substitute	Threads	Substitute	Outlet Pres Adj. Ranges*	Substitute	Gauge	Substitute
1/4"	2	PTF	A	5 to 30 psig (0.3 to 2 bar)	C	With	G**
3/8"	3	ISO G parallel	G	5 to 60 psig (0.3 to 4 bar)	F	Without	N
1/2"	4			10 to 125 psig (0.7 to 8 bar)	L		
3/4"	6			10 to 250 psig (0.7 to 17 bar)	S		
1"	8						
1-1/4"	A						

\* Outlet pressure can be adjusted to pressures in excess of, and less than, those specified. Do not use these units to control pressures outside of the specified ranges.

\*\* A factory installed gauge is only available with PTF threads (A in last position of model number). If a gauge is desired with ISO threads (B or G in last position), order the desired gauge and appropriate reducing bushing from Accessories.

# R24 Micro Trol Pressure Regulator

1/4" to 1-1/4" ports

Typical Performance Characteristics  
 RANGE: 10 to 232 psi (0.7 to 16 bar)

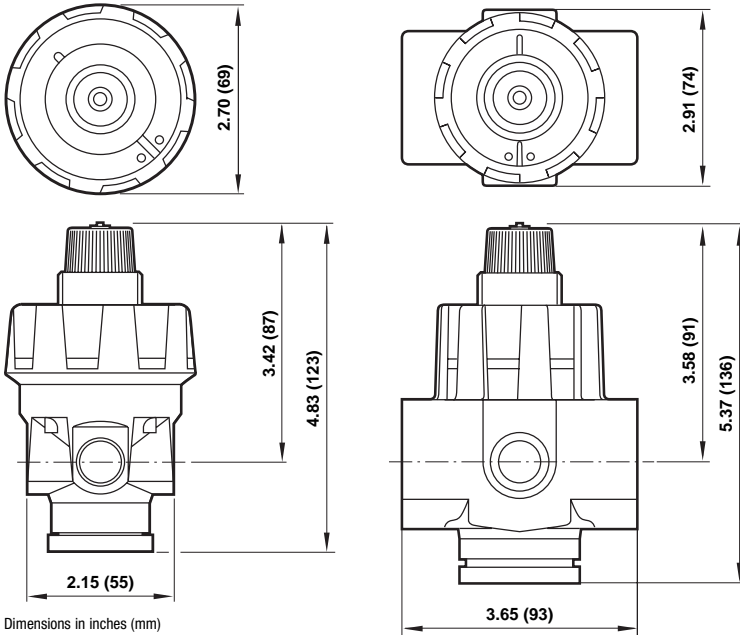

Dimensions in inches (mm)

Panel mounting hole diameter: 1.26" (32 mm)  
 Maximum panel thickness: 0 to 0.12" (3 mm)

## Service Kits

Item	Type	Part number
Service kit	1/4, 3/8, 1/2	5292-52
Service kit	3/4, 1, 1-1/4	5292-53

Service kits include seals, main valve and spring.

